

Zencha Washbowl # 237442..71 / 237442..71 / 237442..71 / 237442..71

| < 420 mm > |

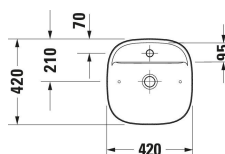
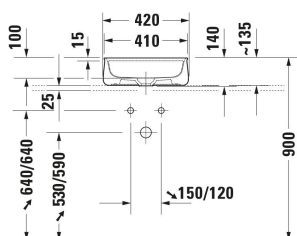

Washbowl	Dimension	Weight	Order number
DuraCeram®, Square, Number of washing areas: 1 Middle, Tap hole platform: Yes, Overflow: No, Incl. ceramic drain cover, Incl. slotted waste, 420 mm			
Colors			
00 White Alpin 13 Anthracite Matt 32 White Satin Matt 67 Grey Satin Matt			
Variant			
● White High Gloss, Number of faucet holes per wash area: 1 Middle, grounded		9.800 kg	237442..71
● Anthracite Matt, Number of faucet holes per wash area: 1 Middle, grounded		9.800 kg	237442..71
● White Satin Matt, Number of faucet holes per wash area: 1 Middle, grounded		9.800 kg	237442..71
● Grey Satin Matt, Number of faucet holes per wash area: 1 Middle, grounded		9.800 kg	237442..71
Sanitary ceramics with the special WonderGliss surface finish will remain clean and attractive-looking for a long time to come. When ordering WonderGliss please add a "1" as eleventh digit to the model number.			
Recommended faucets			
single lever basin mixer S Ceramic cartridge, Height: 155 mm, Spout reach: 91 mm, Connection type for water supply connection: Flexible connecting hoses, Dimension of connection hose: 3/8", Spray mode: Normal spray, Aerator adjustable, recommended operating pressure: 1 - 5 bar, Noise class: I, 121 x 40 mm	121 x 40 mm		C11010002
single lever basin mixer M Ceramic cartridge, Height: 175 mm, Spout reach: 113 mm, Connection type for water supply connection: Flexible connecting hoses, Dimension of connection hose: 3/8", Spray mode: Normal spray, Aerator adjustable, recommended operating pressure: 1 - 5 bar, Noise class: I, 143 x 40 mm	143 x 40 mm		C11020002

Zencha Washbowl # 237442..71 / 237442..71 / 237442..71 /
237442..71

|< 420 mm >|

single lever basin mixer M Chrome, Ceramic cartridge, Height: 217 mm, Spout reach: 125 mm, Connection type for water supply connection: Flexible connecting hoses, Dimension of connection hose: 3/8", Spray mode: Normal spray, Aerator adjustable, Temperature limit adjustable, recommended operating pressure: 1 - 5 bar, 48 x 160 mm	48 x 160 mm	WT1020002
---	-------------	-----------

All drawings contain the necessary measurements which are subject to standard tolerances. They are stated in mm and are non-binding. Exact measurements, in particular for customised installation scenarios, can only be taken from the finished piece.