

**Faucet Accessories Shower rail # UV06000040.. / UV06000040..  
/ UV06000040.. / UV06000040.. / UV06000040.. / UV0600004C..  
/ UV0600004C..**

|< 900 mm >|



Shower rail	Dimension	Weight	Order number
100 mm, Hand shower holder: height adjustable			
<b>Colors</b>			
04 Brushed Bronze 10 Chrome 34 Polished Gold 46 Black Matt 70 Brushed Stainless Steel			
<b>Variant</b>			
mm, bronze Brushed		0.385 kg	UV06000040..
900 mm, Chrome		0.360 kg	UV06000040..
900 mm, Gold Polished		0.385 kg	UV06000040..
900 mm, Black Matt		0.360 kg	UV06000040..
900 mm, Stainless steel Brushed		0.385 kg	UV06000040..
900 mm, Chrome		0.360 kg	UV0600004C..
900 mm, Black Matt		0.360 kg	UV0600004C..
<b>Suitable accessories for 900 mm, Chrome</b>			
Single lever shower mixer for exposed installation Chrome, Dimension of connection hose: 1/2", Ceramic cartridge, recommended operating pressure: 1 - 5 bar, Non-return valve in the hose connection, Noise class: II	209 x 133 mm	1.4 kg	B14230000
Thermostatic shower mixer for exposed installation Chrome, Dimension of connection hose: 1/2", Thermostat cartridge, recommended operating pressure: 1 - 5 bar, Safety lock at 38 °C, Diverter valve, Non-return valve in the hose connection, Noise class: II	260 x 118 mm	1.8 kg	B14220000

**Faucet Accessories Shower rail # UV06000040.. / UV06000040..  
/ UV06000040.. / UV06000040.. / UV06000040.. / UV0600004C..  
/ UV0600004C..**

|< 900 mm >|

Single lever shower mixer for concealed installation Number of outlets: 1, Chrome, Connection type for water supply connection: Basic Set, Ceramic cartridge, Number of outlets: 1, recommended operating pressure: 1 - 5 bar, Escutcheon shape: Round, Diameter escutcheon: 170 mm, Including functional unit, Including trim parts	170 x 86 mm	1.8 kg	B14210010
Single lever shower mixer for concealed installation Number of outlets: 1, Chrome, Connection type for water supply connection: Basic Set, Ceramic cartridge, Number of outlets: 1, recommended operating pressure: 1 - 5 bar, Escutcheon shape: Round, Diameter escutcheon: 170 mm, Including functional unit, Including trim parts	170 x 87 mm	1.75 kg	B24210010
Single lever shower mixer for exposed installation Chrome, Dimension of connection hose: 1/2", Ceramic cartridge, recommended operating pressure: 1 - 5 bar, Non-return valve in the hose connection, Noise class: II	179 x 137 mm	1.3 kg	B24230000
Thermostatic shower mixer for exposed installation Chrome, Dimension of connection hose: 1/2", Thermostat cartridge, recommended operating pressure: 1 - 5 bar, Safety lock at 38 °C, Diverter valve, Non-return valve in the hose connection, Noise class: II	260 x 113.5 mm	1.8 kg	B24220000
Single lever shower mixer for exposed installation Chrome, Dimension of connection hose: 1/2", Ceramic cartridge, recommended operating pressure: 3 - 5 bar, Non-return valve in the hose connection, Flow rate (3 bar): 18,5 l/min	209 x 140 mm	1.33 kg	DE4230000
Single lever shower mixer for concealed installation Number of outlets: 1, Chrome, Connection type for water supply connection: Basic Set, Ceramic cartridge, Number of outlets: 1, recommended operating pressure: 1 - 5 bar, Escutcheon shape: Round, Diameter escutcheon: 170 mm, Including functional unit, Including trim parts	170 x 80 mm	1.8 kg	DE4210010
Single lever shower mixer for concealed installation Number of outlets: 1, Chrome, Connection type for water supply connection: Basic Set, Ceramic cartridge, Number of outlets: 1, recommended operating pressure: 1 - 5 bar, Escutcheon shape: Round, Diameter escutcheon: 170 mm, Including functional unit, Including trim parts	170 x 97 mm	1.8 kg	WT4210010
Single lever shower mixer for exposed installation Chrome, Connection type for water supply connection: S-connections, Dimension of connection hose: 1/2", Centre distance: 150 mm ± 10 mm, Ceramic cartridge, recommended operating pressure: 1 - 5 bar	215 x 128 mm	0.9 kg	N14230000
Single lever mixer concealed set Number of outlets: 1, Chrome, Connection type for water supply connection: Basic Set, Ceramic cartridge, Number of outlets: 1, recommended operating pressure: 1 - 5 bar, Escutcheon shape: Round, Including functional unit, Including trim parts	115 x 83 mm	0.7 kg	N14210007
Hand shower MinusFlow, Spray mode: Rain, Dimensions of water supply connection: 1/2", Flow rate (3 bar): 9 l/min, Silicone nubs	245 x 110 mm	0.16 kg	UV0652014
Single lever shower mixer for exposed installation Chrome, Connection type for water supply connection: S-connections, Dimension of connection hose: 1/2", Centre distance: 150 mm ± 20 mm, Ceramic cartridge, recommended operating pressure: 1 - 5 bar, Non-return valve in the hose connection, Flow rate (3 bar): 17,1 l/min	210 x 114 mm	0.9 kg	A14230001

**Faucet Accessories Shower rail # UV06000040.. / UV06000040..  
/ UV06000040.. / UV06000040.. / UV06000040.. / UV0600004C..  
/ UV0600004C..**

|< 900 mm >|

Single lever shower mixer for exposed installation Dimension of connection hose: 1/2", Ceramic cartridge, recommended operating pressure: 1 - 5 bar, Non-return valve in the hose connection	255 x 106 mm	1.68 kg	CE4230000
Single lever mixer concealed set Number of outlets: 1, Connection type for water supply connection: Basic Set, Ceramic cartridge, Number of outlets: 1, recommended operating pressure: 1 - 5 bar, Escutcheon shape: Round	125 x 72 mm	1.1 kg	CE4210007
Single lever mixer concealed set Number of outlets: 1, Connection type for water supply connection: Basic Set, Ceramic cartridge, Number of outlets: 1, recommended operating pressure: 1 - 5 bar, Escutcheon shape: Round, Including functional unit, Including trim parts	125 x 88 mm	1.17 kg	WA4210007
Single lever mixer concealed set Number of outlets: 1, Connection type for water supply connection: Basic Set, Ceramic cartridge, Number of outlets: 1, recommended operating pressure: 1 - 5 bar, Escutcheon shape: Square, 130x130 mm, Including functional unit, Including trim parts	130 x 76 mm	1.08 kg	MH4210007
Single lever shower mixer for concealed installation Number of outlets: 1, Chrome, Connection type for water supply connection: Basic Set, Ceramic cartridge, Number of outlets: 1, recommended operating pressure: 1 - 5 bar, Escutcheon shape: Round, Diameter escutcheon: 170 mm, Including functional unit, Including trim parts	170 x 86 mm	1.75 kg	N14210010
Single lever shower mixer for concealed installation Number of outlets: 1, Connection type for water supply connection: Basic Set, Ceramic cartridge, Number of outlets: 1, recommended operating pressure: 1 - 5 bar, Escutcheon shape: Round	170 x 82 mm	1.66 kg	CE4210010
<b>Suitable accessories for 900 mm, Chrome, 900 mm, Chrome</b>			
Hand shower Spray mode: Rain, Dimensions of water supply connection: 1/2", Silicone nubs	245 x 110 mm	0.16 kg	UV0650014
Hand shower Spray mode: SoftRain, Rain, IntenseRain, Dimensions of water supply connection: 1/2", Spray mode selection: Rotating blasting disc, Silicone nubs	245 x 110 mm	0.2 kg	UV0650016
<b>Suitable accessories for 900 mm, Chrome, 900 mm, Chrome, 900 mm, Black Matt, 900 mm, Black Matt</b>			
Hand shower Spray mode: Rain, Dimensions of water supply connection: 1/2", Silicone nubs	245 x 110 mm	0.16 kg	UV0650013
Hand shower Spray mode: SoftRain, Rain, IntenseRain, Dimensions of water supply connection: 1/2", Spray mode selection: Rotating blasting disc, Silicone nubs	245 x 110 mm	0.2 kg	UV0650015
Hand shower Spray mode: Rain, Pulse, Mono, Dimensions of water supply connection: 1/2", Spray mode selection: Push button, Silicone nubs	240 x 120 mm	0.24 kg	UV0650017
Stick hand shower Dimensions of water supply connection: 1/2", Silicone nubs	187 x 25 mm	0.14 kg	UV0640001
Stick hand shower Dimensions of water supply connection: 1/2", Silicone nubs	212 x 22 mm	0.18 kg	UV0640002
Single lever shower mixer for exposed installation Dimension of connection hose: 1/2", Ceramic cartridge, recommended operating pressure: 1 - 5 bar, Flow rate (3 bar): 12,6 l/min, Noise class: II	272 x 103 mm	1.69 kg	C14230000

**Faucet Accessories Shower rail # UV06000040.. / UV06000040..  
/ UV06000040.. / UV06000040.. / UV06000040.. / UV0600004C..  
/ UV0600004C..**

|< 900 mm >|

Thermostatic shower mixer for exposed installation Dimension of connection hose: 1/2", Thermostat cartridge, recommended operating pressure: 1 - 5 bar, Safety lock at 38 °C, Non-return valve in the hose connection, Noise class: II	338 x 103 mm	2.13 kg	C14220000
Thermostatic shower mixer for concealed installation Number of outlets: 1, Connection type for water supply connection: Basic Set, Thermostat cartridge, Safety lock at 38 °C, Outlet/Diverter: Shut-off valve, Number of outlets: 1, recommended operating pressure: 1 - 5 bar, Flow rate (3 bar): 20,6 l/min, Escutcheon shape: Square, Including functional unit, Including trim parts	150 x 94 mm	1.8 kg	C14200015
Thermostatic shower mixer for concealed installation Number of outlets: 1, Connection type for water supply connection: Basic Set, Thermostat cartridge, Safety lock at 38 °C, Outlet/Diverter: Shut-off valve, Number of outlets: 1, recommended operating pressure: 1 - 5 bar, Flow rate (3 bar): 20,6 l/min, Escutcheon shape: Round, Diameter escutcheon: 170 mm, Including functional unit, Including trim parts	170 x 94 mm	1.8 kg	C14200016
Single lever shower mixer for concealed installation Number of outlets: 1, Connection type for water supply connection: Basic Set, Ceramic cartridge, Number of outlets: 1, recommended operating pressure: 1 - 5 bar, Escutcheon shape: Square, Including functional unit, Including trim parts	150 x 77 mm	1.63 kg	C14210009
Single lever shower mixer for concealed installation Number of outlets: 1, Connection type for water supply connection: Basic Set, Ceramic cartridge, Number of outlets: 1, recommended operating pressure: 1 - 5 bar, Escutcheon shape: Round, Diameter escutcheon: 170 mm, Including functional unit, Including trim parts	170 x 77 mm	1.66 kg	C14210010
Single lever shower mixer for exposed installation Dimension of connection hose: 1/2", Ceramic cartridge, recommended operating pressure: 1 - 5 bar, Non-return valve in the hose connection	280 x 113 mm	3.4 kg	TU4230000
Single lever shower mixer for concealed installation Number of outlets: 1, Connection type for water supply connection: Basic Set, Ceramic cartridge, Number of outlets: 1, recommended operating pressure: 1 - 5 bar, Escutcheon shape: Round, Including functional unit, Including trim parts	170 x 86 mm	1.8 kg	TU4210010
Hand shower MinusFlow, Spray mode: Rain, Dimensions of water supply connection: 1/2", Flow rate (3 bar): 9 l/min, Silicone nubs	245 x 110 mm	0.16 kg	UV0652013
Hand shower MinusFlow, Spray mode: SoftRain, Rain, IntenseRain, Dimensions of water supply connection: 1/2", Spray mode selection: Rotating blasting disc, Flow rate (3 bar): 9 l/min, Silicone nubs	245 x 110 mm	0.2 kg	UV0652015
Stick hand shower MinusFlow, Flow rate (3 bar): 9 l/min, Silicone nubs	212 x 22 mm	0.18 kg	UV0642002
Single lever shower mixer for exposed installation Dimension of connection hose: 1/2", Ceramic cartridge, recommended operating pressure: 1 - 5 bar	255 x 105 mm	2.07 kg	MH4230000
Single lever shower mixer for concealed installation Number of outlets: 1, Connection type for water supply connection: Basic Set, Ceramic cartridge, Number of outlets: 1, recommended operating pressure: 1 - 5 bar, Escutcheon shape: Square, Including functional unit, Including trim parts	150 x 82 mm	1.75 kg	MH4210010

**Faucet Accessories Shower rail # UV06000040.. / UV06000040..  
/ UV06000040.. / UV06000040.. / UV06000040.. / UV0600004C..  
/ UV0600004C..**

|< 900 mm >|

Single lever shower mixer for concealed installation Number of outlets: 1, Connection type for water supply connection: Basic Set, Ceramic cartridge, Number of outlets: 1, recommended operating pressure: 1 - 5 bar, Escutcheon shape: Round, Including functional unit, Including trim parts	170 x 92 mm	1.8 kg	WA4210010
<b>Suitable accessories for 900 mm, Chrome, 900 mm, Black Matt, 900 mm, Stainless steel Brushed, 900 mm, Gold Polished, mm, bronze Brushed</b>			
Hand shower MinusFlow, Spray mode: Rain, Pulse, Mono, Dimensions of water supply connection: 1/2", Spray mode selection: Push button, Flow rate (3 bar): 9 l/min, Silicone nubs	240 x 120 mm	0.24 kg	UV0652017
Stick hand shower MinusFlow, Flow rate (3 bar): 9 l/min, Silicone nubs	187 x 25 mm	0.14 kg	UV0642001
Single lever shower mixer for exposed installation Connection type for water supply connection: S-connections, Dimension of connection hose: 1/2", Ceramic cartridge, recommended operating pressure: 1 - 5 bar, Non-return valve in the hose connection	216 x 165 mm	1.66 kg	WA4230000
Thermostatic shower mixer for exposed installation 1000 Dimension of connection hose: 1/2", Thermostat cartridge, recommended operating pressure: 1 - 5 bar, Safety lock at 38 °C, Non-return valve in the hose connection	303 x 113 mm	2.25 kg	TH4220000
Hand shower MinusFlow, Spray mode: SoftRain, Rain, IntenseRain, Dimensions of water supply connection: 1/2", Spray mode selection: Rotating blasting disc, Flow rate (3 bar): 9 l/min, Silicone nubs	245 x 110 mm	0.2 kg	UV0652016
<b>Suitable accessories for 900 mm, Chrome, 900 mm, Black Matt</b>			
Hand shower Spray mode: SilkRain, Pulse, Mono, Dimensions of water supply connection: 1/2", Spray mode selection: Push button, Silicone nubs	260 x 130 mm	0.3 kg	UV0650018
Hand shower Silicone nubs		0.29 kg	UV065G018
Shower rail Hand shower holder: height adjustable	810 x 60 mm	1.1 kg	UV0600005
Shower rail 100 mm, Hand shower holder: height adjustable	100 x 70 mm	0.36 kg	UV0600004
Shower rail Hand shower holder: height adjustable	700 x 70 mm	0.32 kg	UV0600003

*All drawings contain the necessary measurements which are subject to standard tolerances. They are stated in mm and are non-binding. Exact measurements, in particular for customised installation scenarios, can only be taken from the finished piece.*

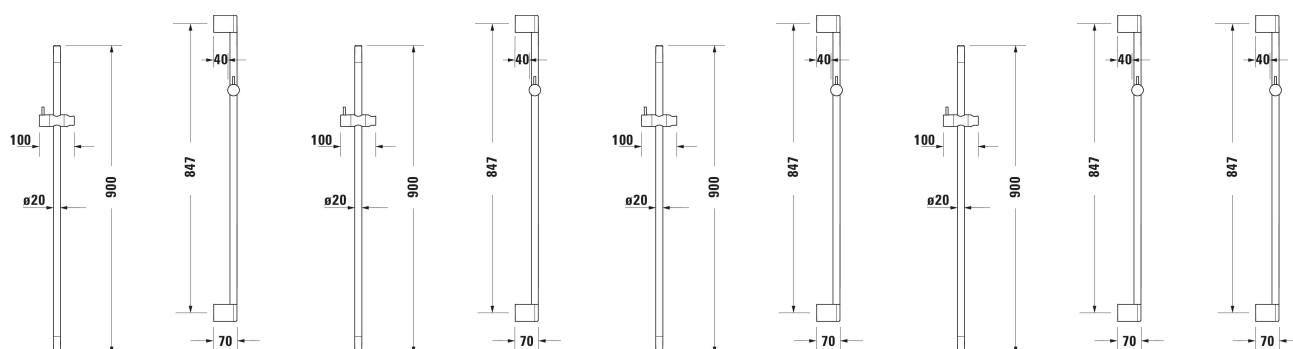

**Faucet Accessories Shower rail** # UV06000040.. / UV06000040..  
/ UV06000040.. / UV06000040.. / UV06000040.. / UV0600004C..  
/ UV0600004C..

---

|< 900 mm >|

